

LID ASSEMBLY SHOWN CLOSED FOR REFERENCES ONLY

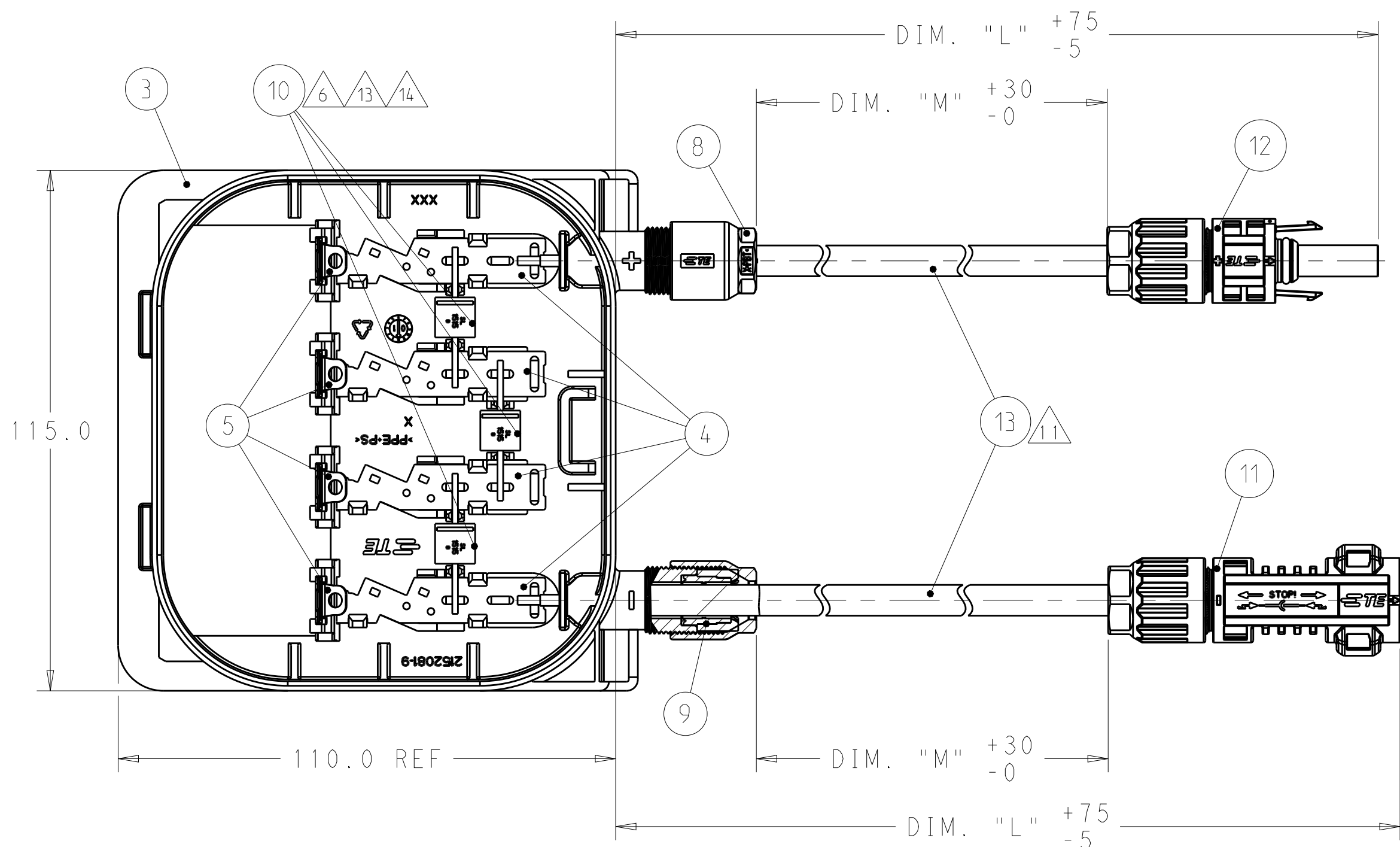

LID ASSEMBLY SHOWN WITHOUT COVER FOR REFERENCES ONLY

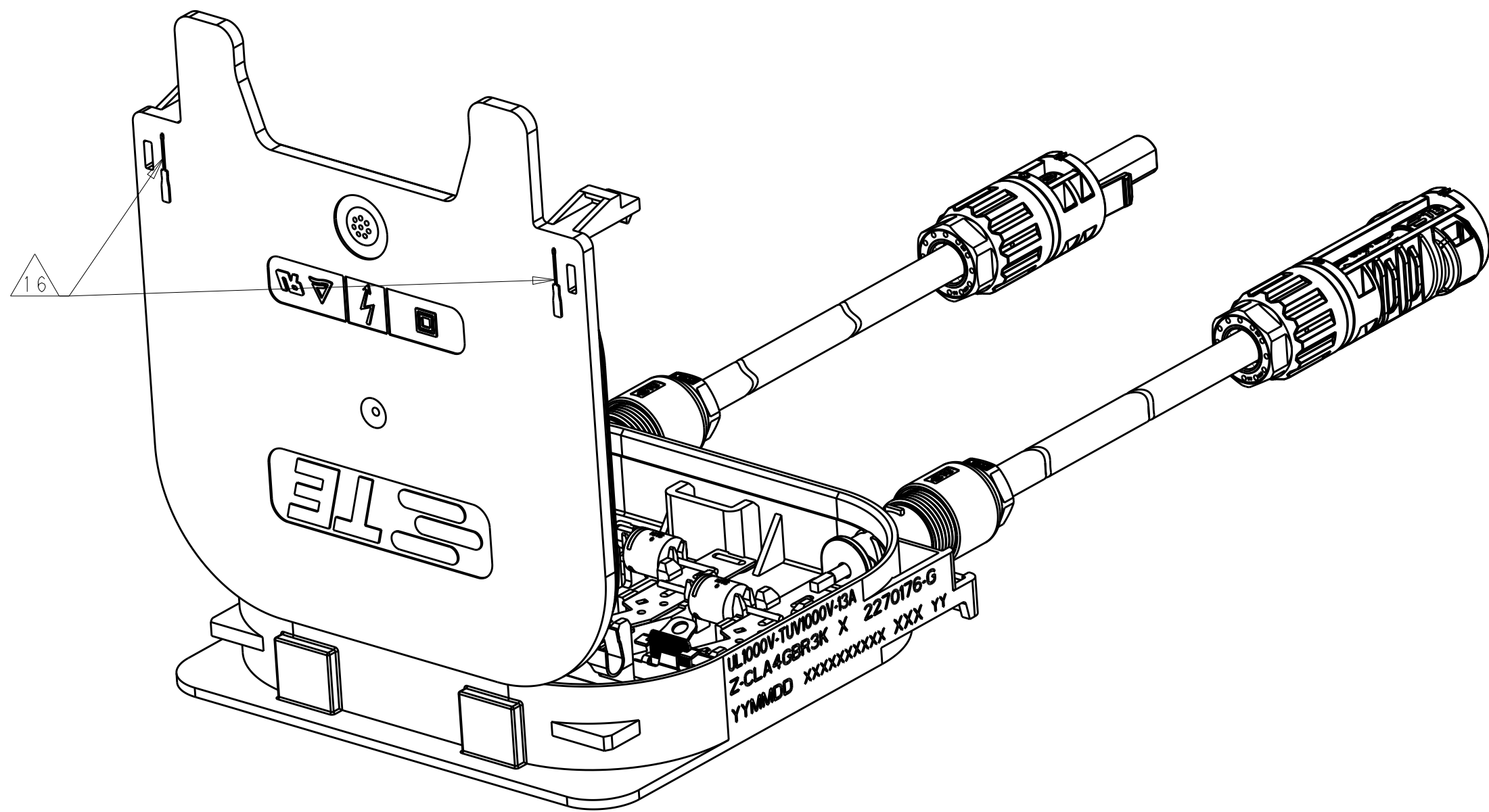

LID ASSEMBLY SHOWN COVER OPEN FOR REFERENCES ONLY

-1 AS SHOWN

												
8-	-11-	-41-	-31-	-21-	-1-	-3-	-2-	-1	PART NUMBERS			
800									CABLE LENGTH "M"			
	1100	1500	1200	1000	1500	1200	1000		CABLE LENGTH "L"			
1	1	1	1	1	-	-	-	14	MOUNTING TAPE 60.0mm x 20.0mm x 1.0mm	LOHMANN	-	
2	2	2	2	2	2	2	2	13	SOLAR CABLE DUAL RATED(TÜV,UL) 4mm ² /12 AWG		BLACK	-
1	1	1	1	1	1	1	1	12	PV4-S SOCKET CONNECTOR ASSY.	BLACK	-	
1	1	1	1	1	1	1	1	11	PV4-S PIN CONNECTOR ASSY.	BLACK	-	
3	3	3	3	3	3	3	3	10	BYPASS DIODE TYPE: SL1515B	  	-	-
2	2	2	2	2	2	2	2	9	PINCH RING SEAL INMOLDED, ASSY	BLACK	PA66/LSR	
2	2	2	2	2	2	2	2	8	CABLE SCREW JOINT	BLACK	PBT	
1	1	1	1	1	1	1	1	7	RING FOR ULTRASONIC WELDING	-	-	
1	1	1	1	1	1	1	1	6	MEMBRANE VENTS	-	-	
4	4	4	4	4	4	4	4	5	S-CLIP	PLAIN	STAINLESS STEEL	
4	4	4	4	4	4	4	4	4	CONTACT RAIL	TIN HOT DIPPED	CuSn	
1	1	1	1	1	1	1	1	3	SOLAR MODULE BOX LOWER PART WITH STANDOFFS	BLACK	PPE+PS	
1	1	1	1	1	1	1	1	2	O-RING SEAL	RED	SILOPREN	
1	1	1	1	1	1	1	1	1	SOLAR MODULE BOX COVER, ASSY. WITH UNIFIED MARKING		BLACK	PPE+PS
QTY. PER ASSY									ITEM-NO.	DESCRIPTION	SURFACE / COLOUR	MATERIAL

THIS DRAWING IS A CONTROLLED DOCUMENT.

DIMENSIONS:
mm

MATERIAL
-

TOLERANCES UNLESS OTHERWISE SPECIFIED:

0 PLC ±2
1 PLC ±2.0
2 PLC ±
3 PLC ±
4 PLC ±
ANGLES ±
FINISH -

WEIGHT
-

CUSTOMER DRAWING

DWN 28APR2016
CHK 28APR2016
Zhang Alex
APVD 28APR2016
Zhong Yuan

PRODUCT SPEC
108-2471-1
APPLICATION SPEC
114-13303-1

SIZE
A1

CAGE CODE
00779

DRAWING NO.
2270176

RESTRICTED TO
-

TE Connectivity

JUNCTION BOX ASSEMBLY, Z-RAIL,
S-CLIP, WITH PV4-S CONNECTOR ASSY.

SCALE 1:1
SHEET 1 OF 2
REV D1

LOC		DIST		REVISONS			
P	LTR	DESCRIPTION		DATE	DWN	APVD	
-	-	SEE SHEET 1		-	-	-	

- 1

COVER NOT ASSEMBLED WITH LOWER PART. ENCLOSE LOOSELY.
- 2

PART NUMBER.
- 3

PRODUCTION DATE (YYMMDD).
- 4

MANUFACTURING LOCATION CODE.
- 5

FOR CABLES PER APPLICATION SPEC. 114-18488-1 WITH OUTER DIAMETER 5.5 - 7.8mm
- 6

DIODE SL1515B ACC. SPEC. 108-94244.
- 7

MODEL CODE ACCORDING TE-SPEC. 404-74000-1.
- 8

CONSECUTIVE SERIAL NUMBER.
- 9

TEST EQUIPMENT NUMBER.
- 10

DIODES WELDED ON CONTACT RAIL
EXCHANGABLE WITH REP-KIT, SEE APPL.SPEC. 114-13303-1.
- 11

SOLAR CABLE WITH UL4703 AND EN50618 APPROVAL.PN 2270259-1 AND 2270260-1 CAN ALSO BE ALTERNATIVELY USED.
- 12

MARK FOR DIODE TYPE, ADDED WITH LASER PRINTER:
B FOR DIODE SL1515B.
E FOR DIODE SL1515E
- 13

DIODE SL1515E ACC. SPEC. 108-106133 CAN ALTERNATIVELY USED.
- 14

ONLY DIODES OF THE SAME TYPE RESP. DESIGNATION ARE PERMITTED FOR USE IN ONE
AND THE SAME SOLAR BOX. ONLY SOLARLOK BOXES WITH THE SAME DIODES ARE
PERMITTED TO PACK IN ONE AND THE SAME CORRUGATED SHIPPING BOX.
- 15

INDICATION FOR JUNCTION BOX ASSY. VOLTAGE AND CURRENT RATINGS.

MOUNTING INSTRUCTION

- FOR COVER ASSY:
1.

MOUNT COVER ITEM NO. 1 AND 2 INTO THE LOWER PART ITEM NO. 3
AND CLOSE IT. (LATCH SNAP IN).
2.

RE-OPEN: PUT IN MARKED OPENING 6 SCREWDRIVER 3mm AND MOVE LATCH
UNTIL LOCKING LATCH FREE THE COVER.
OPEN COVER ITEM NO. 1 AND 2

- 16

PACKAGING: 30 PIECES JUNCTION BOX ASSEMBLY, Z-RAIL, FOIL CLIP PACKED
IN TWO ROWS OF 15 BOXES EACH ON TOP OF CORRUGATED LAYER PAD .
IN CORRUGATED SHIPPING BOX PER TE-SPEC. 107-18052.
JUNCTION BOX ASSEMBLY, Z-RAIL, FOIL COVERED WITH CORRUGATED LAYER PAD.
30 PIECES JUNCTION BOX LID ASSEMBLY, Z-RAIL, FOIL ITEM No. 1 PACKED
ON TOP OF CORRUGATED LAYER.
15 IN THE FIRST AND SECOND LEVEL PACKAGED IN ESD PLASTIC BAG AND
PUT ON THE CORRUGATED LAYER PAD.
ON TOP USED AS COVER - PAPER CUSHION.

PACKAGING UNIT: 30 PIECES
STANDARD PACKAGING QUANTITY: 30 PIECES

- 17

PACKAGING: 35 PIECES SOLAR MODULE BOX WITH CABLE, ASSY IN TWO ROWS OF 17 AND 18 BOXES ON TOP OF
CORRUGATED LAYER PAD IN CORRUGATED SHIPPING BOX PER TE-SPEC. 107-18052.
SOLAR MODULE BOX MEDOT WITH CABLE, ASSY COVERED WITH CORRUGATED LAYER PAD.
35 PIECES SOLARBOX LID ASSY'S ITEM NO. 1 STACKED.
3 x 5 STACKS PACKAGED IN ESD PLASTIC BAG AND PUT ON THE CORRUGATED LAYER PAD.
ON TOP USED AS COVER PAPER CUSHION.

PACKAGING UNIT: 35 PIECES
STANDARD PACKAGING QUANTITY: 35 PIECES

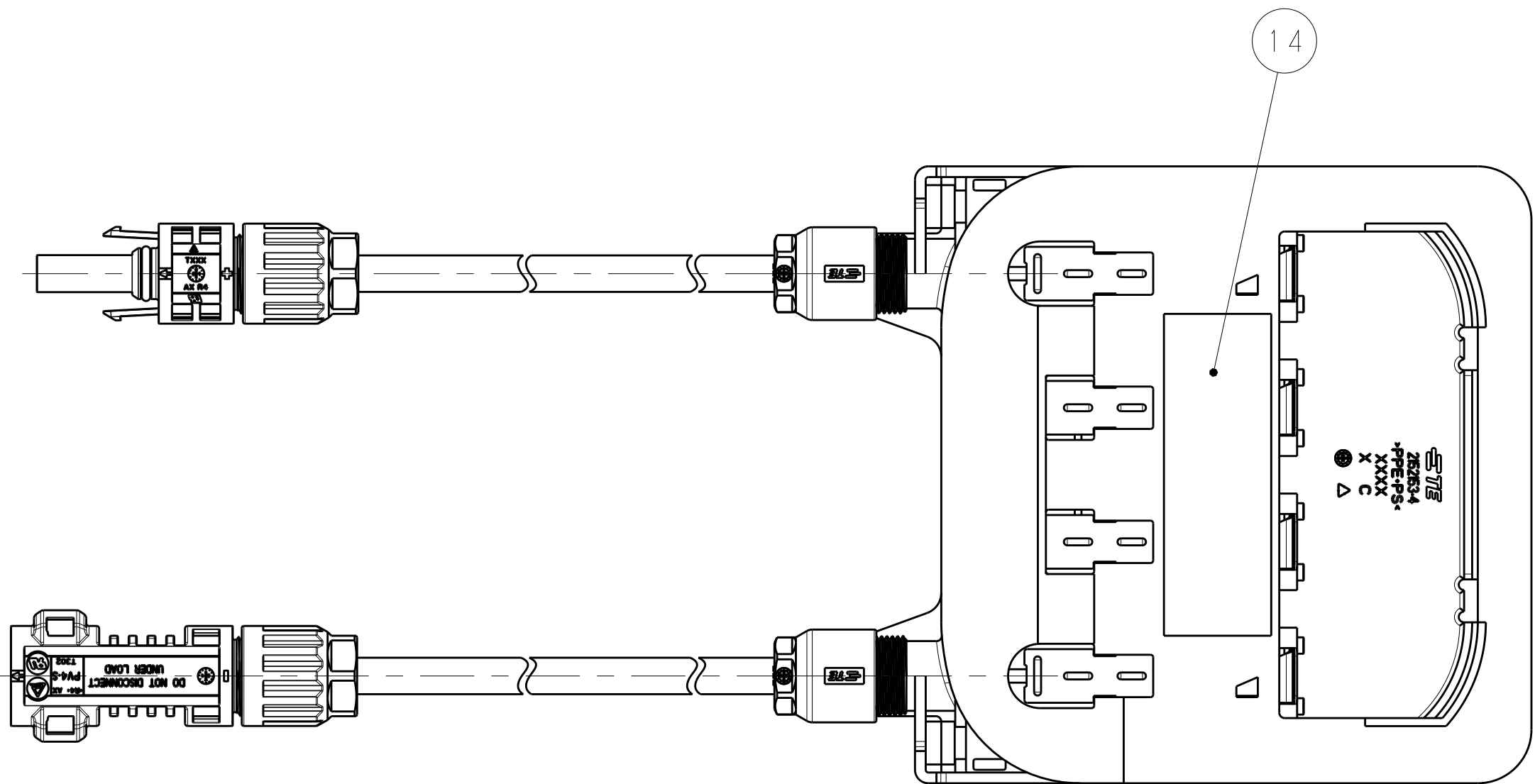

REAR VIEW
1--X WITH MOUNTING TAPE AS SHOWN

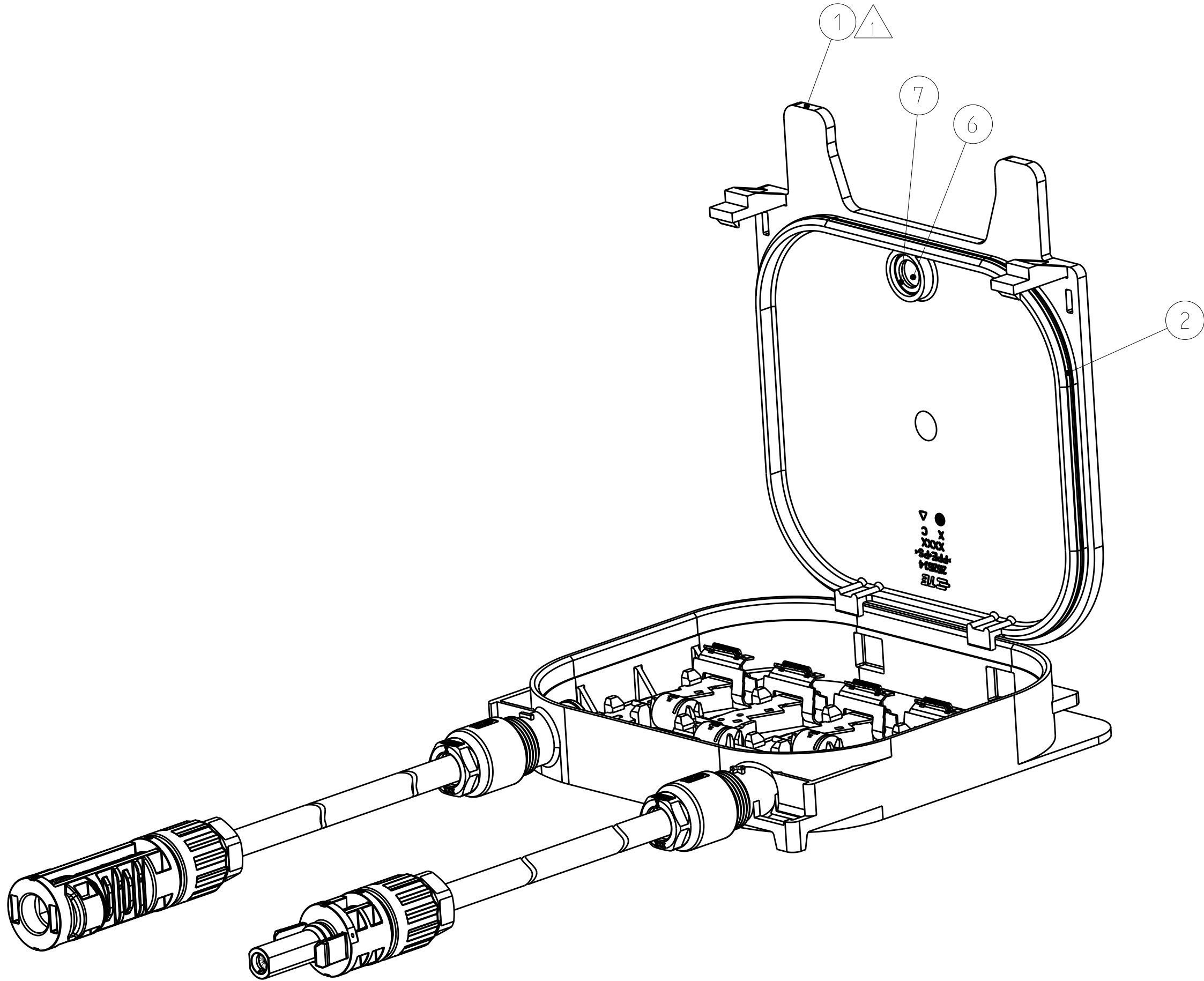

LID ASSEMBLY SHOWN COVER OPEN FOR REFERENCES ONLY

THIS DRAWING IS A CONTROLLED DOCUMENT.		DWN RAGHU	28APR2016	TE Connectivity	
		CHK ZHANG ALEX	28APR2016		
DIMENSIONS:		APVD ZHONG YUAN	28APR2016	NAME JUNCTION BOX ASSEMBLY, Z-RAIL, S-CLIP, WITH PV4-S CONNECTOR ASSY.	
mm		PRODUCT SPEC		SIZE	
		108-2471-1		CAGE CODE	
		APPLICATION SPEC		DRAWING NO	
		114-13303-1		A100779	
MATERIAL		WEIGHT		C=2270176	
		CUSTOMER DRAWING		RESTRICTED TO	
				SCALE	
				1:1	
				SHEET	
				2	
				OF	
				2	
				REV	
				D1	